

AREA CALCULATION
 Area of Land = 3.82 acres = 15459.55 sqm as per deed
 Adjoining road width = 59 M
 Permissible F.A.R. = 4.00
 Proposed F.A.R. = 3.99
 Permissible FAR Built Up Area = 61638.20 Sqm
 PROPOSED FAR BUILT UP AREA = 61729.21 sqm
 Proposed Ground Coverage = 35% = 5410.84 Sqm
 Proposed Ground Coverage = 5386.92 Sqm = 34.85%
 Green area = 3147.83 Sqm (20.36%)
 Block C building height = 77.25 M.
 Block B building height = 49.9 M.
 Block A building height = 30.0 M.

| Sl. No. | Room No. | Room Name | Area (sqm) | Volume (cu m) | Remarks |
|---------|----------|-----------|------------|---------------|---------|
| 1 | 101 | Room | 10.00 | 300.00 | |
| 2 | 102 | Room | 10.00 | 300.00 | |
| 3 | 103 | Room | 10.00 | 300.00 | |
| 4 | 104 | Room | 10.00 | 300.00 | |
| 5 | 105 | Room | 10.00 | 300.00 | |
| 6 | 106 | Room | 10.00 | 300.00 | |
| 7 | 107 | Room | 10.00 | 300.00 | |
| 8 | 108 | Room | 10.00 | 300.00 | |
| 9 | 109 | Room | 10.00 | 300.00 | |
| 10 | 110 | Room | 10.00 | 300.00 | |
| 11 | 111 | Room | 10.00 | 300.00 | |
| 12 | 112 | Room | 10.00 | 300.00 | |
| 13 | 113 | Room | 10.00 | 300.00 | |
| 14 | 114 | Room | 10.00 | 300.00 | |
| 15 | 115 | Room | 10.00 | 300.00 | |
| 16 | 116 | Room | 10.00 | 300.00 | |
| 17 | 117 | Room | 10.00 | 300.00 | |
| 18 | 118 | Room | 10.00 | 300.00 | |
| 19 | 119 | Room | 10.00 | 300.00 | |
| 20 | 120 | Room | 10.00 | 300.00 | |
| 21 | 121 | Room | 10.00 | 300.00 | |
| 22 | 122 | Room | 10.00 | 300.00 | |
| 23 | 123 | Room | 10.00 | 300.00 | |
| 24 | 124 | Room | 10.00 | 300.00 | |
| 25 | 125 | Room | 10.00 | 300.00 | |
| 26 | 126 | Room | 10.00 | 300.00 | |
| 27 | 127 | Room | 10.00 | 300.00 | |
| 28 | 128 | Room | 10.00 | 300.00 | |
| 29 | 129 | Room | 10.00 | 300.00 | |
| 30 | 130 | Room | 10.00 | 300.00 | |
| 31 | 131 | Room | 10.00 | 300.00 | |
| 32 | 132 | Room | 10.00 | 300.00 | |
| 33 | 133 | Room | 10.00 | 300.00 | |
| 34 | 134 | Room | 10.00 | 300.00 | |
| 35 | 135 | Room | 10.00 | 300.00 | |
| 36 | 136 | Room | 10.00 | 300.00 | |
| 37 | 137 | Room | 10.00 | 300.00 | |
| 38 | 138 | Room | 10.00 | 300.00 | |
| 39 | 139 | Room | 10.00 | 300.00 | |
| 40 | 140 | Room | 10.00 | 300.00 | |
| 41 | 141 | Room | 10.00 | 300.00 | |
| 42 | 142 | Room | 10.00 | 300.00 | |
| 43 | 143 | Room | 10.00 | 300.00 | |
| 44 | 144 | Room | 10.00 | 300.00 | |
| 45 | 145 | Room | 10.00 | 300.00 | |
| 46 | 146 | Room | 10.00 | 300.00 | |
| 47 | 147 | Room | 10.00 | 300.00 | |
| 48 | 148 | Room | 10.00 | 300.00 | |
| 49 | 149 | Room | 10.00 | 300.00 | |
| 50 | 150 | Room | 10.00 | 300.00 | |
| 51 | 151 | Room | 10.00 | 300.00 | |
| 52 | 152 | Room | 10.00 | 300.00 | |
| 53 | 153 | Room | 10.00 | 300.00 | |
| 54 | 154 | Room | 10.00 | 300.00 | |
| 55 | 155 | Room | 10.00 | 300.00 | |
| 56 | 156 | Room | 10.00 | 300.00 | |
| 57 | 157 | Room | 10.00 | 300.00 | |
| 58 | 158 | Room | 10.00 | 300.00 | |
| 59 | 159 | Room | 10.00 | 300.00 | |
| 60 | 160 | Room | 10.00 | 300.00 | |
| 61 | 161 | Room | 10.00 | 300.00 | |
| 62 | 162 | Room | 10.00 | 300.00 | |
| 63 | 163 | Room | 10.00 | 300.00 | |
| 64 | 164 | Room | 10.00 | 300.00 | |
| 65 | 165 | Room | 10.00 | 300.00 | |
| 66 | 166 | Room | 10.00 | 300.00 | |
| 67 | 167 | Room | 10.00 | 300.00 | |
| 68 | 168 | Room | 10.00 | 300.00 | |
| 69 | 169 | Room | 10.00 | 300.00 | |
| 70 | 170 | Room | 10.00 | 300.00 | |
| 71 | 171 | Room | 10.00 | 300.00 | |
| 72 | 172 | Room | 10.00 | 300.00 | |
| 73 | 173 | Room | 10.00 | 300.00 | |
| 74 | 174 | Room | 10.00 | 300.00 | |
| 75 | 175 | Room | 10.00 | 300.00 | |
| 76 | 176 | Room | 10.00 | 300.00 | |
| 77 | 177 | Room | 10.00 | 300.00 | |
| 78 | 178 | Room | 10.00 | 300.00 | |
| 79 | 179 | Room | 10.00 | 300.00 | |
| 80 | 180 | Room | 10.00 | 300.00 | |
| 81 | 181 | Room | 10.00 | 300.00 | |
| 82 | 182 | Room | 10.00 | 300.00 | |
| 83 | 183 | Room | 10.00 | 300.00 | |
| 84 | 184 | Room | 10.00 | 300.00 | |
| 85 | 185 | Room | 10.00 | 300.00 | |
| 86 | 186 | Room | 10.00 | 300.00 | |
| 87 | 187 | Room | 10.00 | 300.00 | |
| 88 | 188 | Room | 10.00 | 300.00 | |
| 89 | 189 | Room | 10.00 | 300.00 | |
| 90 | 190 | Room | 10.00 | 300.00 | |
| 91 | 191 | Room | 10.00 | 300.00 | |
| 92 | 192 | Room | 10.00 | 300.00 | |
| 93 | 193 | Room | 10.00 | 300.00 | |
| 94 | 194 | Room | 10.00 | 300.00 | |
| 95 | 195 | Room | 10.00 | 300.00 | |
| 96 | 196 | Room | 10.00 | 300.00 | |
| 97 | 197 | Room | 10.00 | 300.00 | |
| 98 | 198 | Room | 10.00 | 300.00 | |
| 99 | 199 | Room | 10.00 | 300.00 | |
| 100 | 200 | Room | 10.00 | 300.00 | |

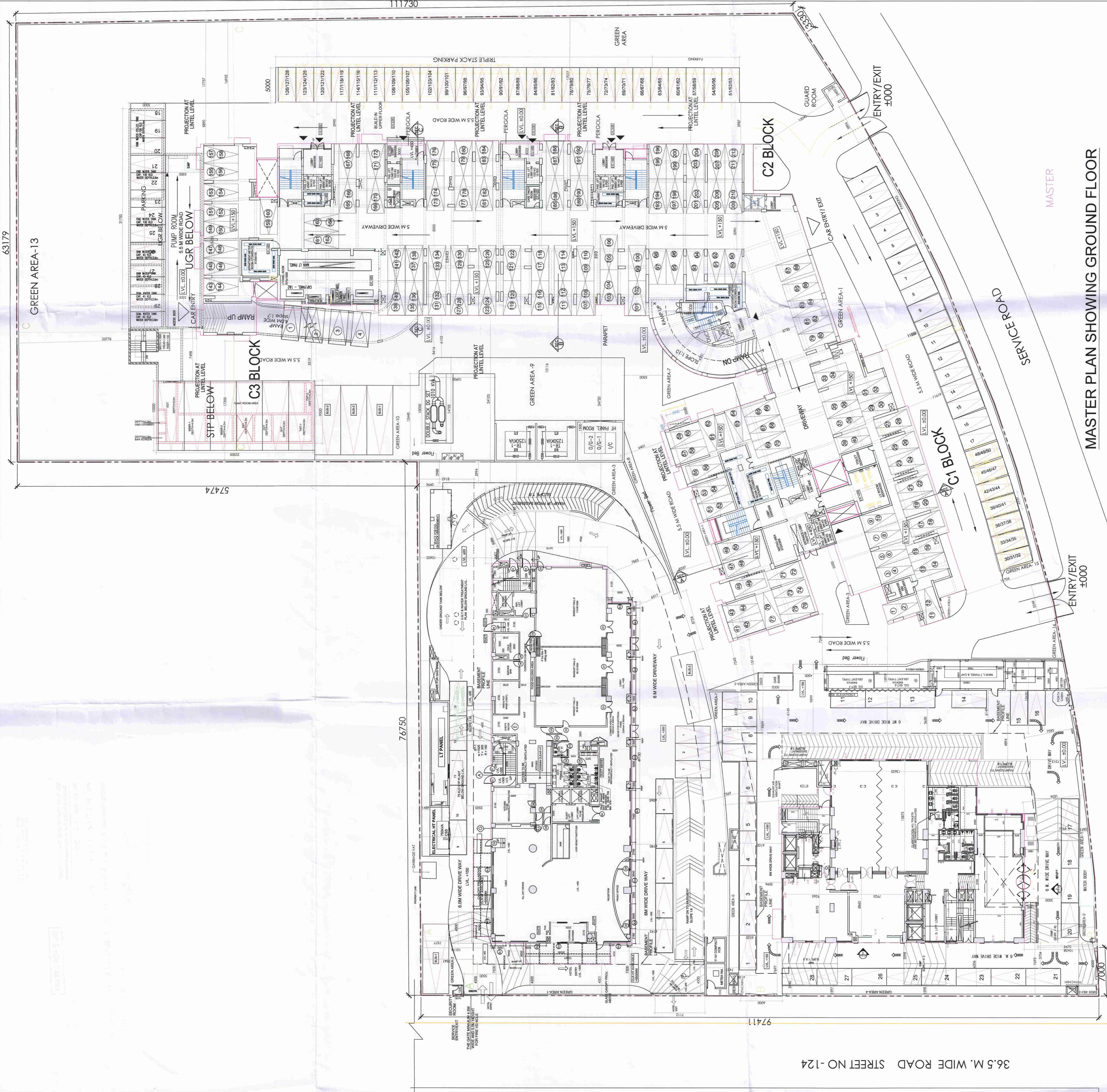

PROJECT:
 REVISED SITE PLAN FOR PROPOSED HOTEL & SERVICE APT.
 & RESIDENTIAL COMPLEX AT PREMISES NO.30-1111, PLOT
 NO. BG-9, NEW TOWN, KOLKATA.
TITLE: MASTER PLAN

- NOTES:**
1. ALL DIMENSIONS ARE IN MM UNLESS OTHERWISE SPECIFIED.
 2. ALL DIMENSIONS ARE TO FACE UNLESS OTHERWISE SPECIFIED.
 3. ALL DIMENSIONS ARE TO FACE UNLESS OTHERWISE SPECIFIED.
 4. ALL DIMENSIONS ARE TO FACE UNLESS OTHERWISE SPECIFIED.
 5. THIS DRAWING SHOULD BE READ ONLY AND NOT TO BE SCALED.
 6. ALL DIMENSIONS ARE TO FACE UNLESS OTHERWISE SPECIFIED.
 7. ALL DIMENSIONS ARE TO FACE UNLESS OTHERWISE SPECIFIED.
 8. ALL DIMENSIONS ARE TO FACE UNLESS OTHERWISE SPECIFIED.
 9. ALL DIMENSIONS ARE TO FACE UNLESS OTHERWISE SPECIFIED.
 10. ALL DIMENSIONS ARE TO FACE UNLESS OTHERWISE SPECIFIED.
 11. THIS DRAWING SHOULD BE USED FOR SANCTION PURPOSE ONLY.
 12. TO BE READ WITH INDIVIDUAL FLOOR PLAN OF BLOCK A,B,C, VIDE
 2016/AR/ANK/1/SD/MP-01 TO B-15, 2016/AR/ANK/1/SD/MP-01 TO C-18

UNDERSTANDING BY THE APPLICANT:

1. I/WE CONFORM THAT THE BUILDING APPROVED TO BE UNDERTAKEN SHALL BE STRICTLY IN ACCORDANCE WITH THE ACT AND THE RULES AND REGULATIONS IN FORCE.
2. I/WE CONFORM THAT THE BUILDING APPROVED TO BE UNDERTAKEN SHALL BE CONSTRUCTED IN ACCORDANCE WITH THE ACT AND THE RULES AND REGULATIONS IN FORCE.
3. I/WE CONFORM THAT THE BUILDING APPROVED TO BE UNDERTAKEN SHALL BE CONSTRUCTED IN ACCORDANCE WITH THE ACT AND THE RULES AND REGULATIONS IN FORCE.

APPLICANT:
 KANAKA DEVI
 17th September 2020/20
TOWN PLANNER:
 TPEE/ANKDA/01/2014

DATE OF THE ARCHITECT:
 29.12.2016

ARCHITECT: KANAKA DEVI
 ANK/ANKDA/01/2014
 54/10, DEBENDRA CHANDRA DEY ROAD
 KOLKATA - 700042

ARCHITECT: KANAKA DEVI
 ANK/ANKDA/01/2014
 54/10, DEBENDRA CHANDRA DEY ROAD
 KOLKATA - 700042

ARCHITECT: KANAKA DEVI
 ANK/ANKDA/01/2014
 54/10, DEBENDRA CHANDRA DEY ROAD
 KOLKATA - 700042

ARCHITECT: KANAKA DEVI
 ANK/ANKDA/01/2014
 54/10, DEBENDRA CHANDRA DEY ROAD
 KOLKATA - 700042

MASTER PLAN SHOWING GROUND FLOOR

MASTER

MASTER

MASTER PLAN SHOWING GROUND FLOOR

PARTY'S COPY

APPROVED FOR CONSTRUCTION
Any unauthorized construction done in violation
of the provisions, will warrant revocation of all
construction permission.

STRUCTURAL DRAWINGS, STRUCTURAL
DESIGN CALCULATIONS & SOIL TEST
REPORT ARE NOT CHECKED AND NOT
FOR RECORD ONLY.

LINE OF TOP OF THE SOCCOM
ALONG THE EXISTING LINE OF
PROPERTY. THE EXISTING LINE OF
PROPERTY IS NOT TO BE USED FOR
CONSTRUCTION. THE EXISTING LINE OF
PROPERTY IS NOT TO BE USED FOR
CONSTRUCTION.

VALID FOR 5 YEARS

NEW TOWN SQUARE DEVELOPMENT AUTHORITY
No. and date: 18 Oct. 2017
PIN: R30011120170104

SHRUTI CHATURVEDI
Chief Architect
New Town Square Development Authority

Building Particulars P2 + G + XXIII Staired assembly ramping ac-
c. No. 80-1111.